

Tür

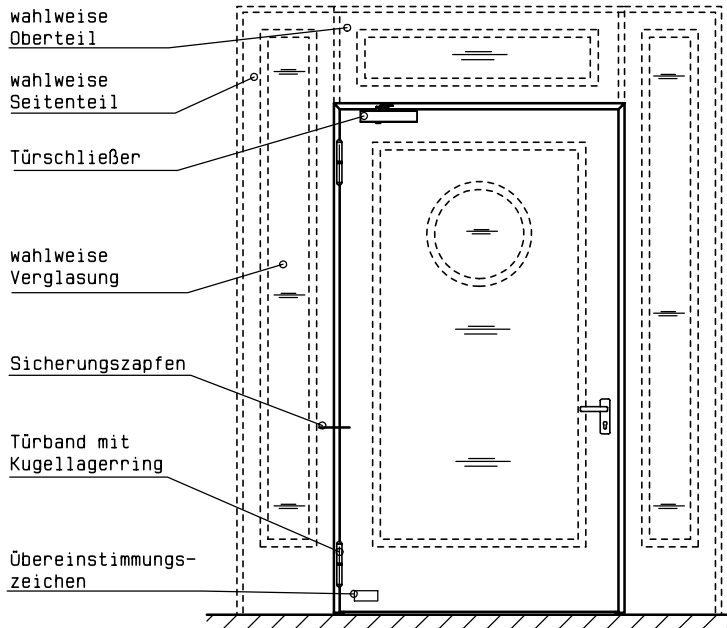

Wandklappe + Tür

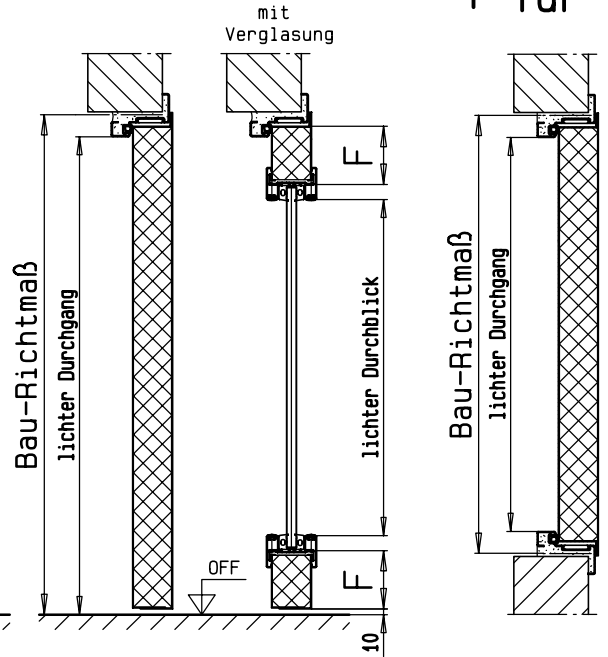

Wandklappe

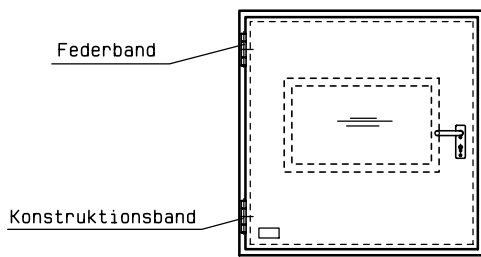

**Scheibengröße und
Scheibenform variabel**
 F = Friesbreite mind. 90 mm

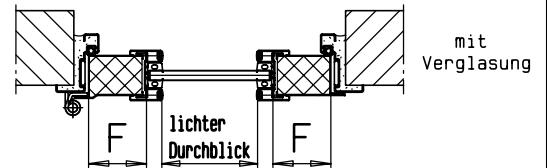
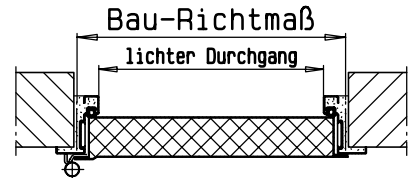

Einbauvarianten

Einbau in

Mauerwerk/
Beton

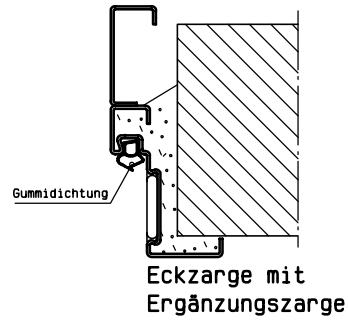
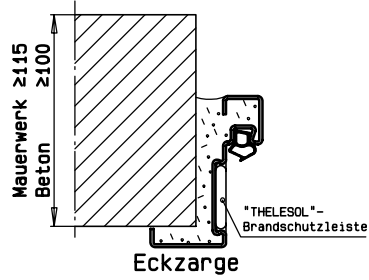

Mauerwerk/
Beton

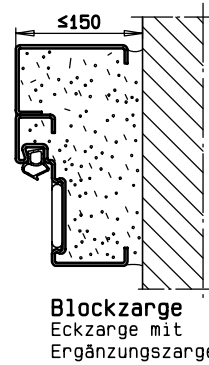
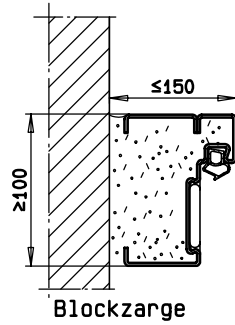

Montagewand
F90

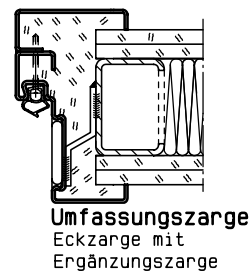
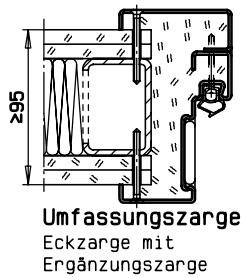

Stahlträger/
Stahlstütze

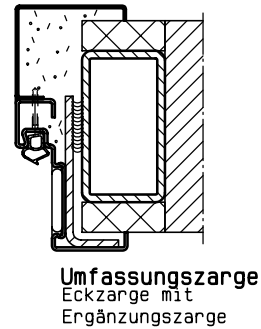
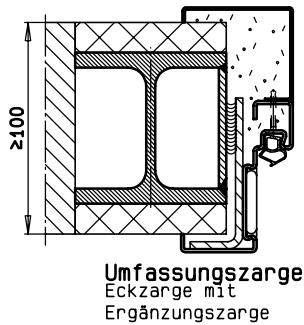

Porenbeton

